

subject to amendments

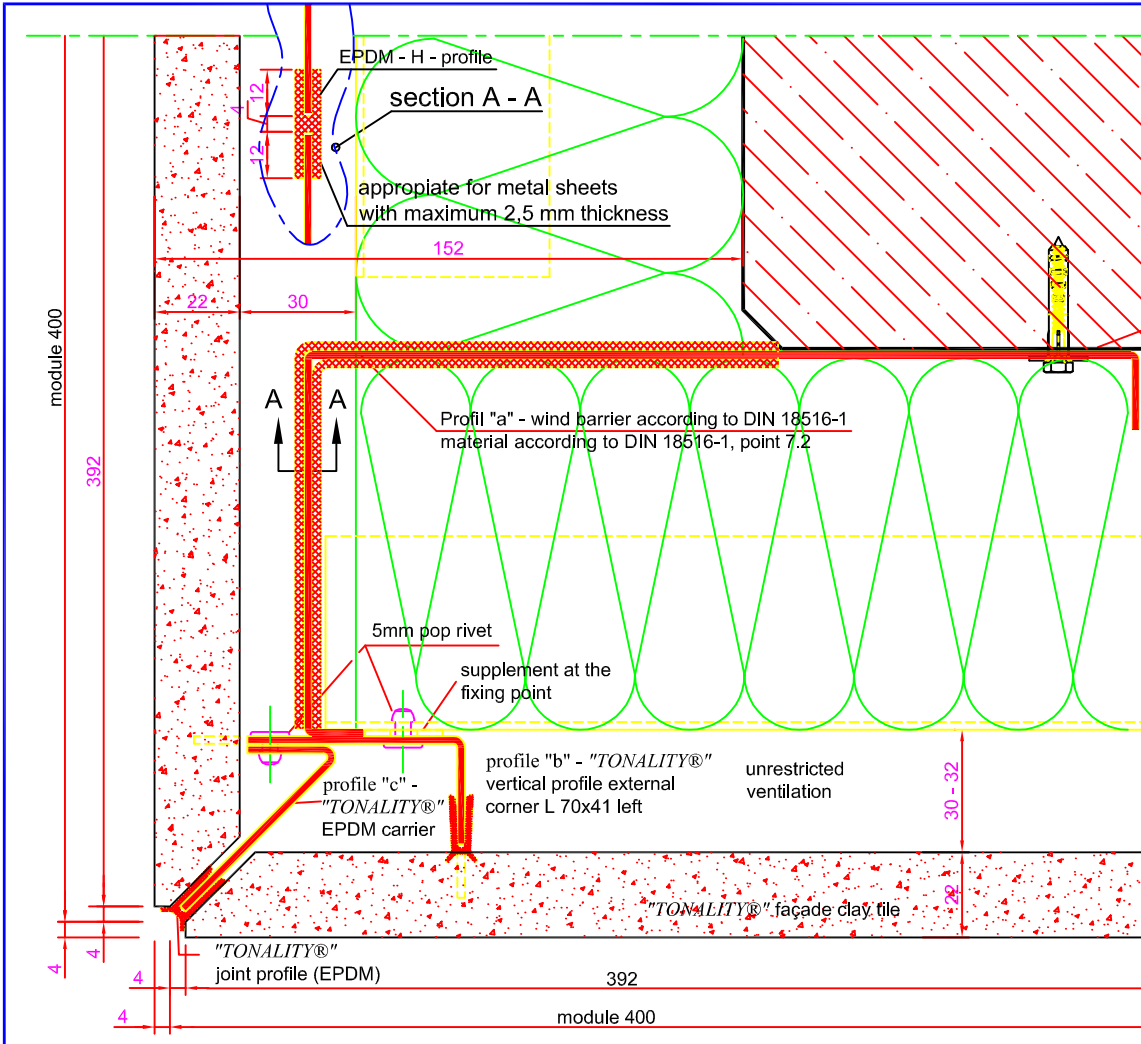

joints due to increased building tolerances by suitable means  
e.g. compressed EPDM tape

reference to DIN 18516-1  
item 5.1.2 windload

The "TONALITY®" - clay tile façade fulfills the requirements according to DIN 18512-1 item 5.1.2  
Thus the reduced wind loads at the building corner area can be used.  
Therefore a wind barrier at the building corner has to be installed.

subject to amendments